

KEY FACTS FOR BUYERS

Ash Lodge, 15, Churchfield Road, Walton-on-thames, KT12

April 2022

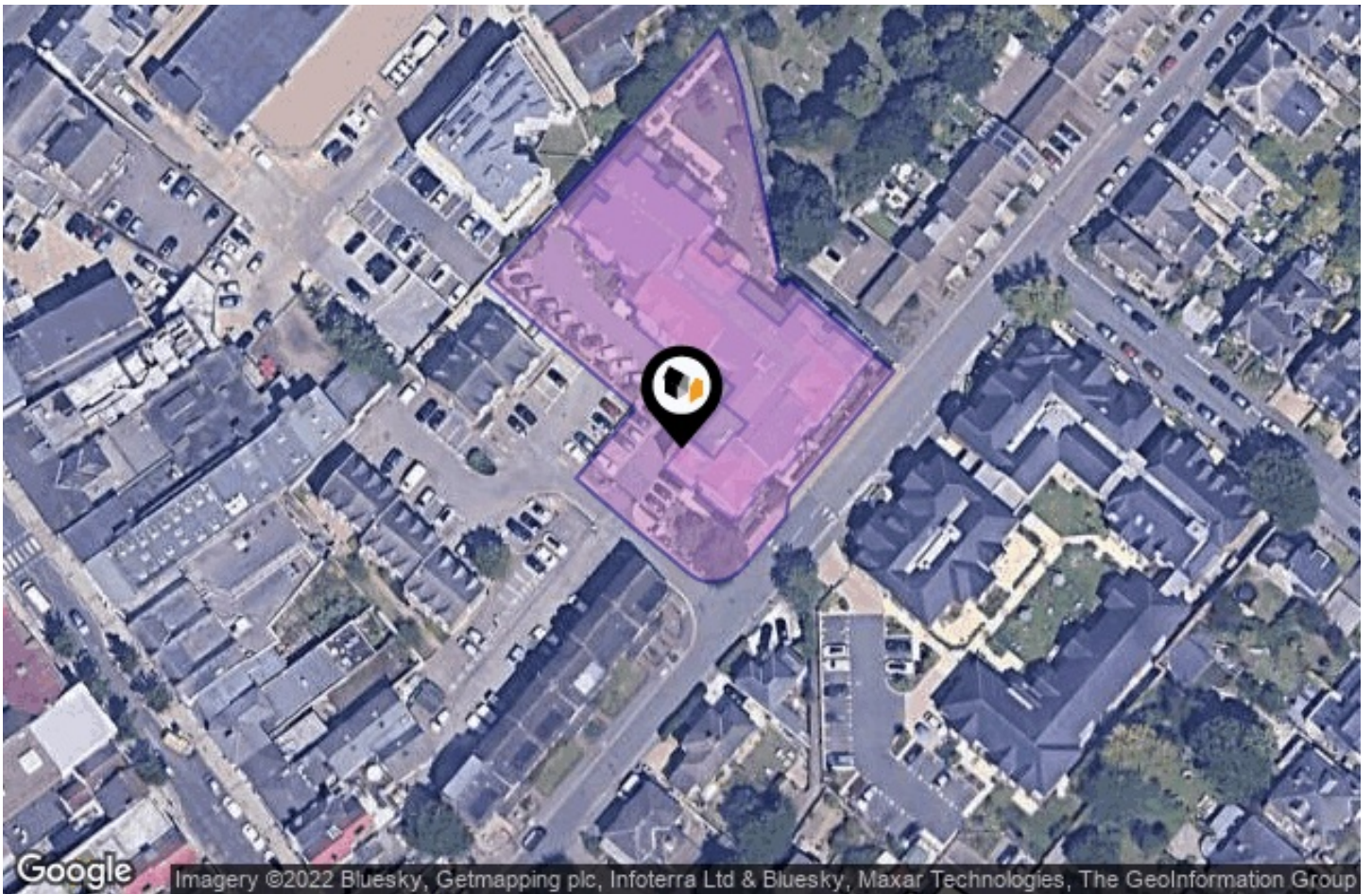

A guide to this property and the local area

James Neave

38 High Street Walton on Thames Surrey KT12 1DE
01932 221 331
hannah@jamesneave.co.uk
www.jamesneave.co.uk



PROPERTY OVERVIEW

ALL TITLES RELATED TO THIS PROPERTY

Freehold Title Plan

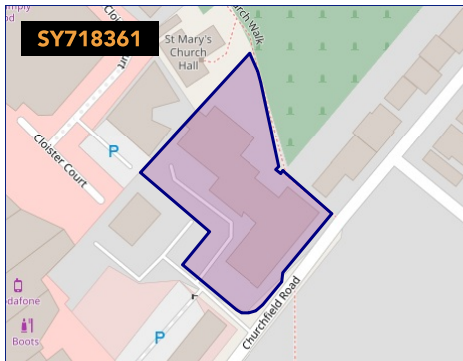

Multiple Leasehold Title Plans Detected

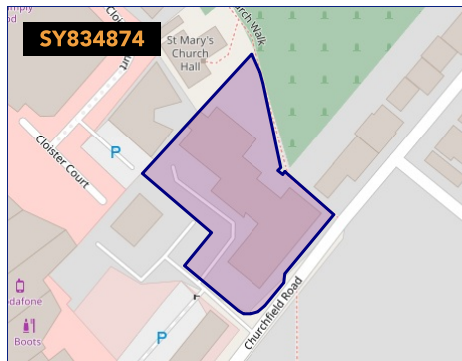
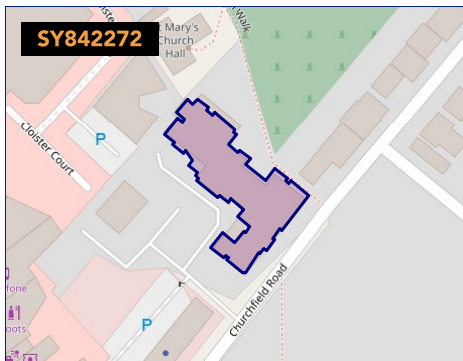

Multiple Leasehold Titles Detected

In instances where multiple leasehold titles are detected at an address, there is not enough data to accurately match a leasehold title to a map polygon. Here, we present the term lengths for the leaseholds found at this address.

Start Date	End Date	Lease Term	Term Remaining
-	-	-	-
01 Oct 2015	01 Oct 2140	125 years	118 years

James Neave

38 High Street Walton on Thames Surrey KT12 1DE
01932 221 331
hannah@jamesneave.co.uk
www.jamesneave.co.uk

PROPERTY OVERVIEW

ASH LODGE, 15, CHURCHFIELD ROAD, WALTON-ON-THAMES, KT12

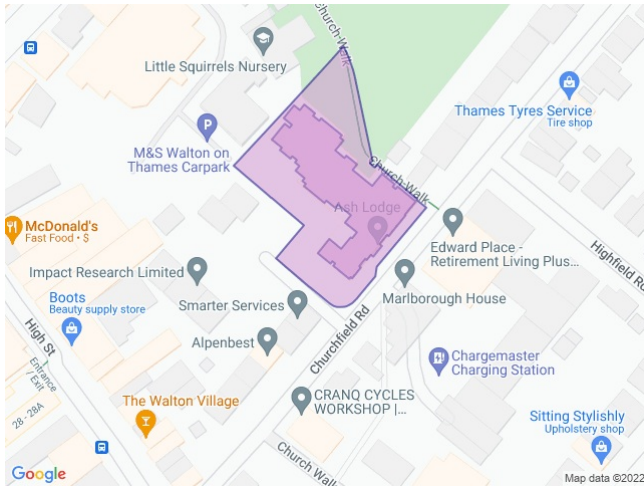







 Boundary (Land Registry Title Plan)



PROPERTY KEY FACTS

Flat / Maisonette	
Floor Area:	742.71 ft ² 69.00 m ²
Plot Size:	1.11 acres
Council Tax Band:	D
Annual Cost:	£2,159.03
Land Registry Title Number:	SY842272
Tenure:	Leasehold
Lease Start Date:	-
Lease End Date:	-
Lease Term:	-
Term Remaining:	-
£/sqft:	£680.96

AREA KEY FACTS

Local Authority:	ELMBRIDGE
Flood Risk:	Very Low
Conservation Area:	No
Predicted Broadband Speeds	
Basic:	20 Mbps
Mobile Coverage (based on voice calls made indoors)	
EE:	
Three:	
O2:	
Vodafone:	
Satellite / Fibre TV Availability	
BT:	
Sky:	
Virgin:	

PLANNING HISTORY

No Planning Records Available

James Neave

38 High Street Walton on Thames Surrey KT12 1DE
01932 221 331
hannah@jamesneave.co.uk
www.jamesneave.co.uk

PROPERTY OVERVIEW

PHOTO GALLERY



James Neave

38 High Street Walton on Thames Surrey KT12 1DE
01932 221 331
hannah@jamesneave.co.uk
www.jamesneave.co.uk

PROPERTY OVERVIEW

PHOTO GALLERY



James Neave

38 High Street Walton on Thames Surrey KT12 1DE
01932 221 331
hannah@jamesneave.co.uk
www.jamesneave.co.uk

PROPERTY OVERVIEW

FLOORPLANS

ASH LODGE, SURREY KT12

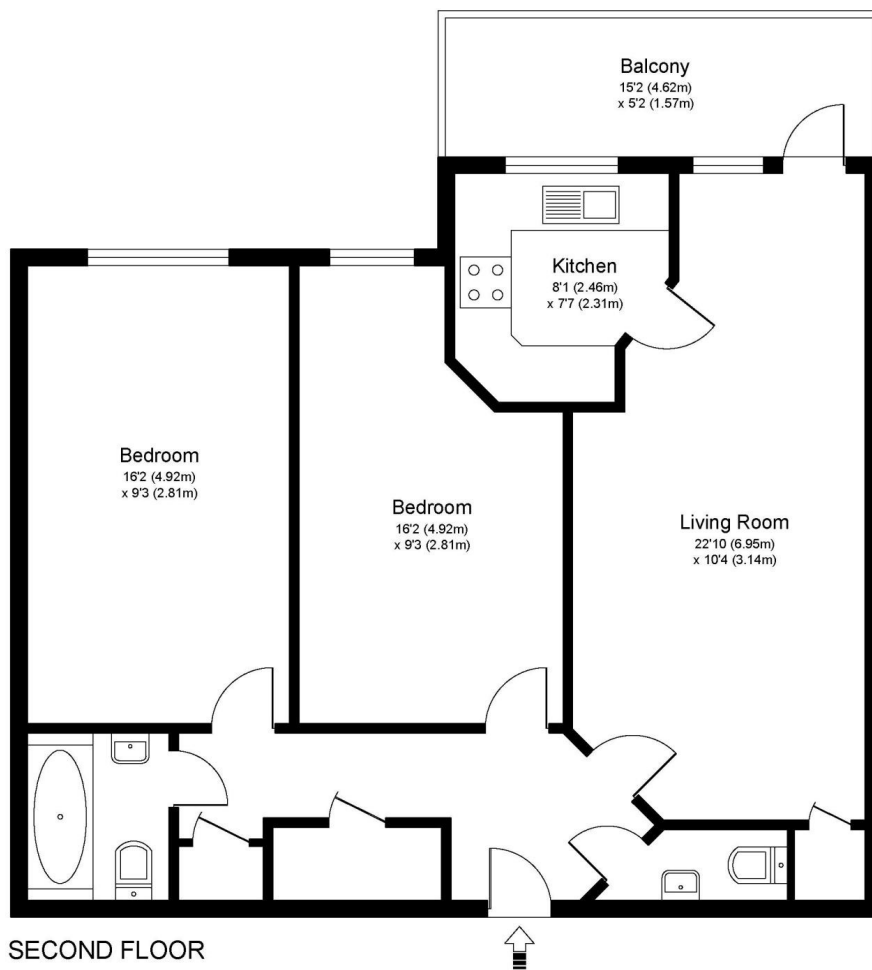

Approximate Gross Internal Floor Area: 64 m sq / 685 sq ft

Whilst every attempt has been made to ensure the accuracy of the floor plan contained here, measurements of doors, windows and rooms are approximate and no responsibility is taken for any error, omission or misstatements. These plans are not to scale and are for representation purposes only as defined by RICS Code of Measuring Practice and should be used as such by any prospective purchaser. Specifically no guarantee is given on total square footage of the property if quoted on this plan. Any figure given is for initial guidance only and should not be relied on as a basis of valuation.

James Neave

38 High Street Walton on Thames Surrey KT12 1DE
01932 221 331
hannah@jamesneave.co.uk
www.jamesneave.co.uk

PROPERTY OVERVIEW

EPC

15, Churchfield Road, KT12

Energy rating
B

Valid until 12.10.2025

Score	Energy rating	Current	Potential
92+	A		
81-91	B		
69-80	C	81 B	81 B
55-68	D		
39-54	E		
21-38	F		
1-20	G		

Additional EPC Data

No Additional EPC data available

James Neave

38 High Street Walton on Thames Surrey KT12 1DE
01932 221 331
hannah@jamesneave.co.uk
www.jamesneave.co.uk

LOCAL AREA

NEARBY SCHOOLS & RATINGS

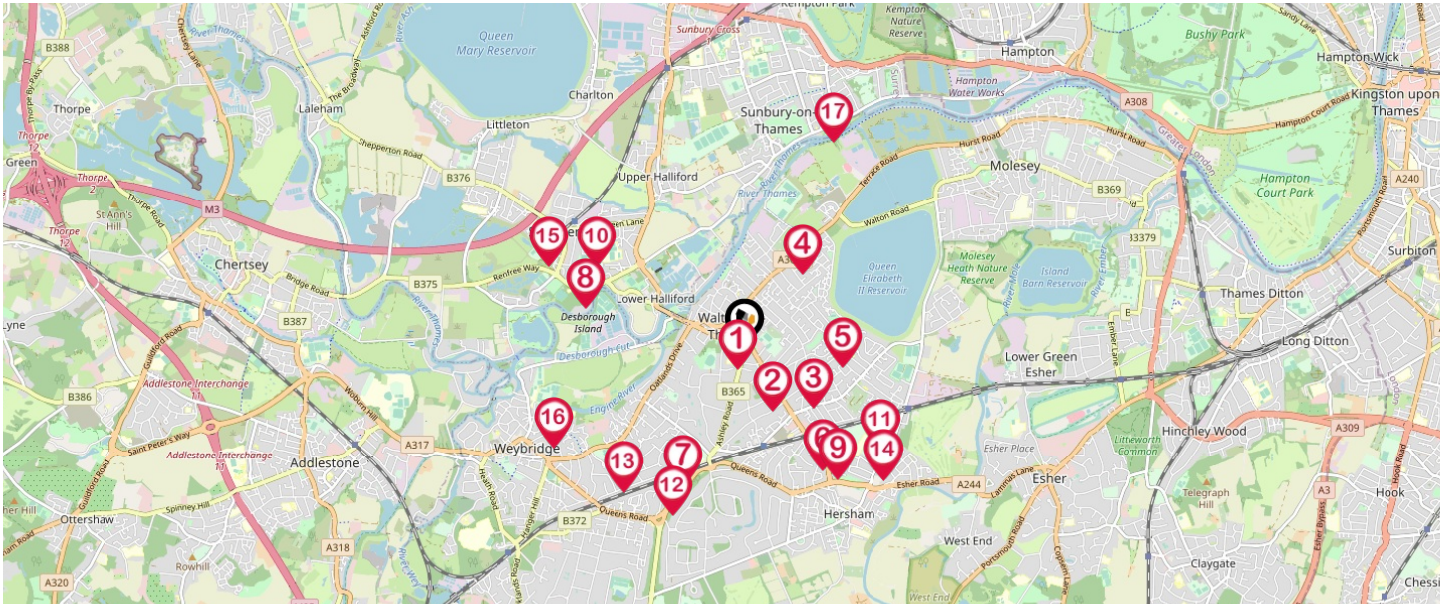

Pin	School Details	Rating	Pupils	Distance	Nursery	Primary	Secondary	College	Private
1	Ashley Church of England Primary School	-	567	0.16 Miles	<input type="checkbox"/>	<input checked="" type="checkbox"/>	<input type="checkbox"/>	<input type="checkbox"/>	<input type="checkbox"/>
2	Westward School	-	125	0.53 Miles	<input type="checkbox"/>	<input checked="" type="checkbox"/>	<input type="checkbox"/>	<input type="checkbox"/>	<input checked="" type="checkbox"/>
3	The Danesfield Manor School	-	129	0.71 Miles	<input checked="" type="checkbox"/>	<input checked="" type="checkbox"/>	<input type="checkbox"/>	<input type="checkbox"/>	<input checked="" type="checkbox"/>
4	Grovelands Primary School	Good	513	0.72 Miles	<input checked="" type="checkbox"/>	<input checked="" type="checkbox"/>	<input type="checkbox"/>	<input type="checkbox"/>	<input type="checkbox"/>
5	Walton Oak Primary School	-	473	0.77 Miles	<input checked="" type="checkbox"/>	<input checked="" type="checkbox"/>	<input type="checkbox"/>	<input type="checkbox"/>	<input type="checkbox"/>
6	Three Rivers Academy	Good	1039	1.08 Miles	<input type="checkbox"/>	<input type="checkbox"/>	<input checked="" type="checkbox"/>	<input checked="" type="checkbox"/>	<input type="checkbox"/>
7	Cleves School	-	720	1.1 Miles	<input type="checkbox"/>	<input checked="" type="checkbox"/>	<input type="checkbox"/>	<input type="checkbox"/>	<input type="checkbox"/>
8	Halliford School	-	419	1.18 Miles	<input type="checkbox"/>	<input type="checkbox"/>	<input checked="" type="checkbox"/>	<input checked="" type="checkbox"/>	<input checked="" type="checkbox"/>
9	Bell Farm Primary School	Good	660	1.21 Miles	<input type="checkbox"/>	<input checked="" type="checkbox"/>	<input type="checkbox"/>	<input type="checkbox"/>	<input type="checkbox"/>
10	Thamesmead School	Good	1013	1.23 Miles	<input type="checkbox"/>	<input type="checkbox"/>	<input checked="" type="checkbox"/>	<input type="checkbox"/>	<input type="checkbox"/>
11	Cardinal Newman Catholic Primary School	Good	405	1.27 Miles	<input type="checkbox"/>	<input checked="" type="checkbox"/>	<input type="checkbox"/>	<input type="checkbox"/>	<input type="checkbox"/>
12	Walton Leigh School	Outstanding	79	1.33 Miles	<input type="checkbox"/>	<input type="checkbox"/>	<input checked="" type="checkbox"/>	<input checked="" type="checkbox"/>	<input type="checkbox"/>
13	Oatlands School	Outstanding	268	1.37 Miles	<input type="checkbox"/>	<input checked="" type="checkbox"/>	<input type="checkbox"/>	<input type="checkbox"/>	<input type="checkbox"/>
14	North East Surrey Secondary Short Stay School	Good	31	1.43 Miles	<input type="checkbox"/>	<input type="checkbox"/>	<input checked="" type="checkbox"/>	<input type="checkbox"/>	<input type="checkbox"/>
15	St Nicholas CofE Primary School	Good	557	1.54 Miles	<input type="checkbox"/>	<input checked="" type="checkbox"/>	<input type="checkbox"/>	<input type="checkbox"/>	<input type="checkbox"/>
16	St James CofE Primary School	Good	447	1.57 Miles	<input type="checkbox"/>	<input checked="" type="checkbox"/>	<input type="checkbox"/>	<input type="checkbox"/>	<input type="checkbox"/>
17	Beaulerc Infant and Nursery School	Good	152	1.68 Miles	<input checked="" type="checkbox"/>	<input checked="" type="checkbox"/>	<input type="checkbox"/>	<input type="checkbox"/>	<input type="checkbox"/>

James Neave

38 High Street Walton on Thames Surrey KT12 1DE
 01932 221 331
 hannah@jamesneave.co.uk
 www.jamesneave.co.uk

LOCAL AREA

NEAREST TRANSPORT LINKS

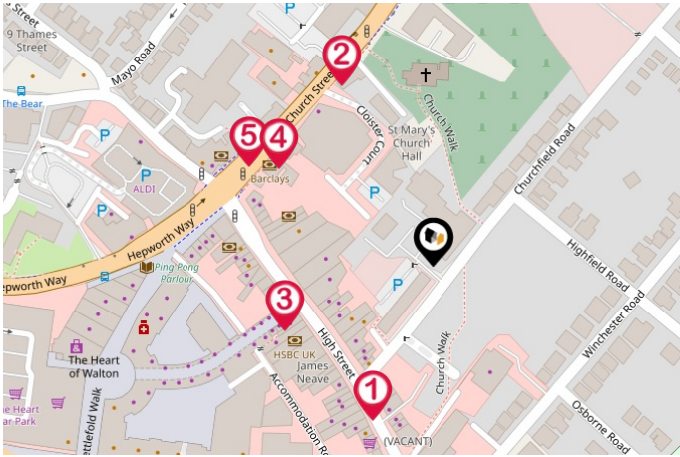

BUS STOPS/STATIONS

- 1 - High Street | 0.08 miles
- 2 - Church Street | 0.09 miles
- 3 - High Street | 0.07 miles
- 4 - Church Street | 0.08 miles
- 5 - Church Street | 0.1 miles

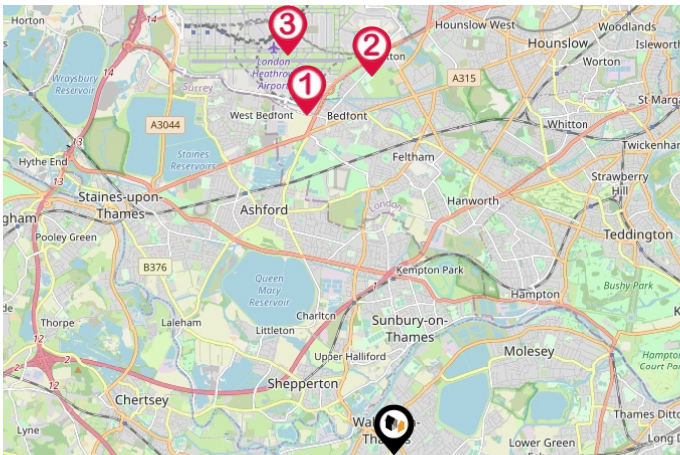

LOCAL CONNECTIONS

- 1 - Heathrow Terminal 4 Underground Station | 5.16 miles
- 2 - Hatton Cross Underground Station | 5.59 miles
- 3 - Heathrow Terminals 2 & 3 Underground Station | 6.09 miles

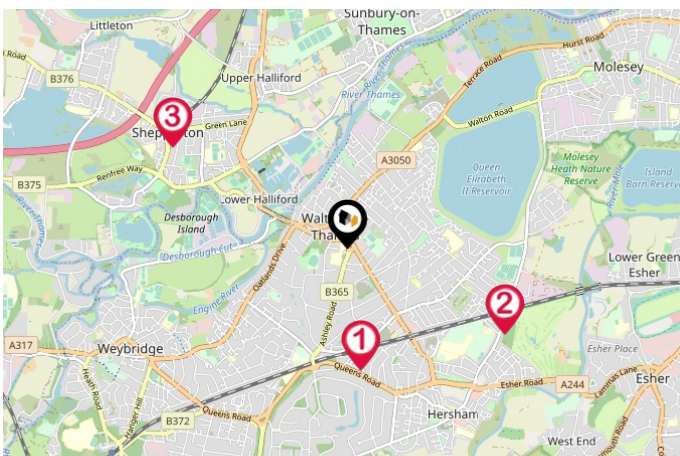

NATIONAL RAIL STATIONS

- 1 - Walton-on-Thames Rail Station | 0.91 miles
- 2 - Hersham Rail Station | 1.35 miles
- 3 - Shepperton Rail Station | 1.47 miles

James Neave

38 High Street Walton on Thames Surrey KT12 1DE
 01932 221 331
hannah@jamesneave.co.uk
www.jamesneave.co.uk

LOCAL AREA

NEAREST TRANSPORT LINKS

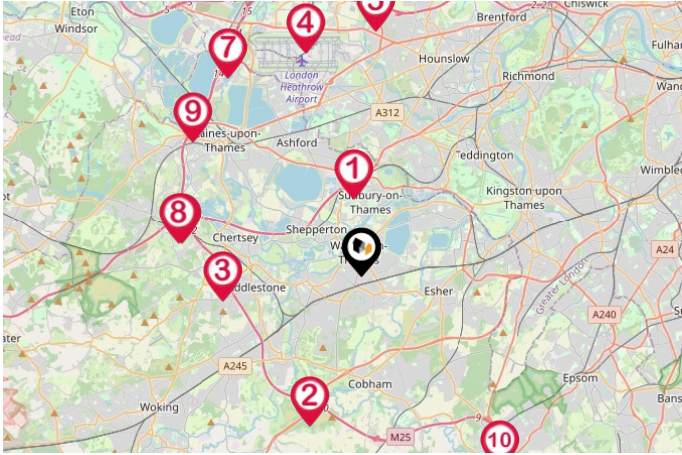

TRUNK ROADS/MOTORWAYS

- 1 - M3 J1 | 2.3 miles
- 2 - M25 J10 | 4.64 miles
- 3 - M25 J11 | 4.03 miles
- 4 - M4 J4A | 6.81 miles
- 5 - M4 J3 | 7.31 miles
- 6 - M25 J12 | 5.26 miles
- 7 - M25 J14 | 7 miles
- 8 - M3 J2 | 5.38 miles
- 9 - M25 J13 | 6.28 miles
- 10 - M25 J9 | 7.12 miles

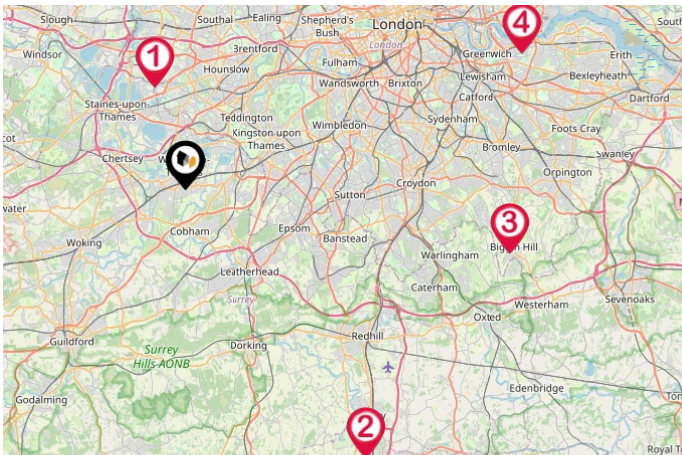

AIRPORTS/HELIPADS

- 1 - London Heathrow Airport | 6.31 miles
- 2 - London Gatwick Airport | 19.31 miles
- 3 - Biggin Hill Airport | 19.82 miles
- 4 - London City Airport | 21.73 miles

James Neave

38 High Street Walton on Thames Surrey KT12 1DE
01932 221 331
hannah@jamesneave.co.uk
www.jamesneave.co.uk

LOCAL MARKET

HOUSE PRICE STATISTICS FOR KT12

10 YEAR HISTORY OF AVERAGE PRICES BY PROPERTY TYPE

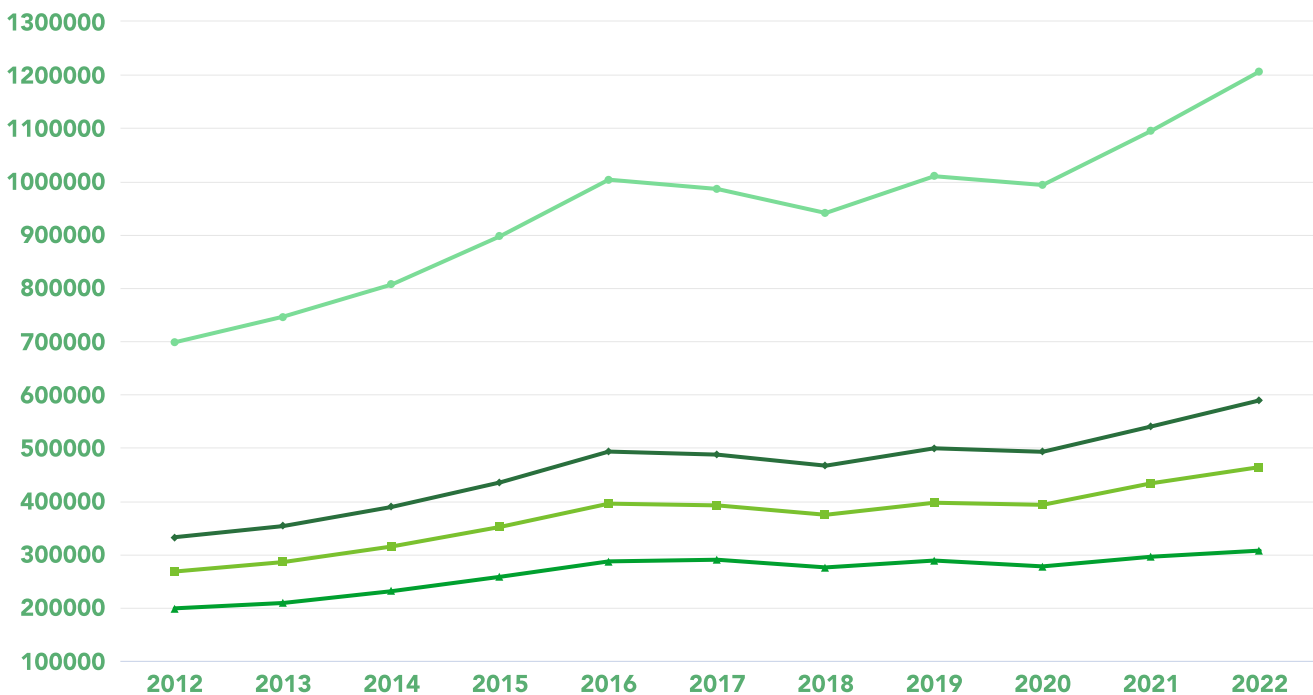

FLAT
+ 54.54%



TERRACED
+ 73.24%



SEMI-DETACHED
+ 77.35%



DETACHED
+ 72.85%

James Neave

38 High Street Walton on Thames Surrey KT12 1DE
01932 221 331
hannah@jamesneave.co.uk
www.jamesneave.co.uk

DATA QUALITY

James Neave is committed to comprehensive property data being made available upfront to make the home buying and selling process quicker, easier and cheaper. Which is why they have partnered with Sprift, the UK's leading supplier of property specific data.

Data Partners:



Contains public sector information licensed under the Open Government Licence v3.0

The information contained in this report is for general information purposes only and to act as a guide to the best way to market your property and the asking price.

Sprift Technologies Limited aggregate this data from a wide variety of sources and while we endeavour to keep the information up to date and correct, we make no representations or warranties of any kind, express or implied, about the completeness, accuracy, reliability, of the information or related graphics contained in this report for any purpose. Any reliance you place on such information is therefore strictly at your own risk. In no event will we be liable for any loss or damage including without limitation, indirect or consequential loss or damage, or any loss or damage whatsoever arising from loss of data or profits arising out of, or in connection with, the use of this report.

Information produced by HM Land Registry. Crown copyright and database rights 2022